

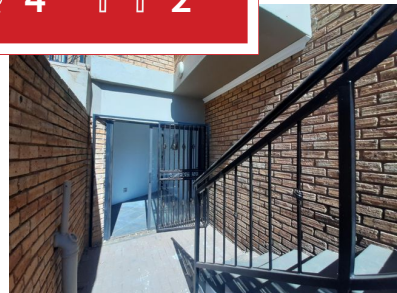

5 4 2

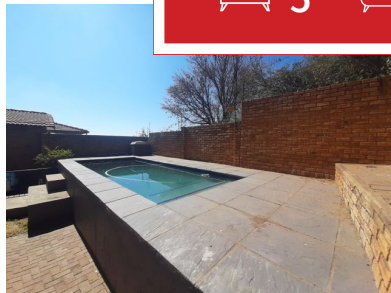
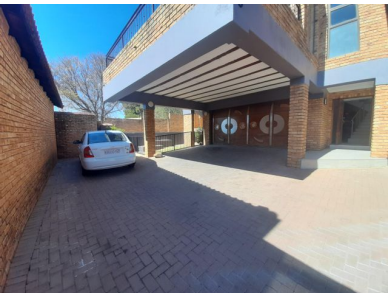

5 Bedroom home in Estate in Kenmare

Spectacular face brick, multi-level 5 bedroom home in Kenmare, in a small secure estate which only has 4 properties. This charming modern home with panoramic views is in the heart of Kenmare, close to major routes and local amenities, shopping malls, schools, hospitals, etc.

The property features the following:

Main house

Ground Floor

- Entrance hall
- Enclosed lounge and room with bathroom

has space for a private lounge and walk in mirrored wardrobes.

- 2 bathrooms, one of which is the main en-suite.

Outbuildings

- Double automated garage leading directly into the house.

- Teen pad or staff quarters

Extras

- Swimming pool

- Garden

This spacious house is perfect for a big family or for an entertainer

Monthly Bond Repayment

R22,192.05

Calculated over 20 years at 11%
with no deposit.

Bond Costs

R34,625.00

These calculations are only a guide. Please ask
your conveyancer for exact calculations

Transfer Costs

R86,947.00

Monthly Rates

R1,138



INTERIOR

Bedrooms	5
Bathrooms	4
Kitchens	1
Recep. Rooms	2
Furnished	Yes

EXTERIOR

Carports / Parkings	1
Security	Yes
Dom. Accom.	0
Pool	Yes
Views	Maybe

SIZES

Floor Size	350m ²
Land Size	400m ²



Juliet Mxhakaza
Candidate Property Practitioner

072 149 1015
juliet@finehome.co.za