

3 2 2

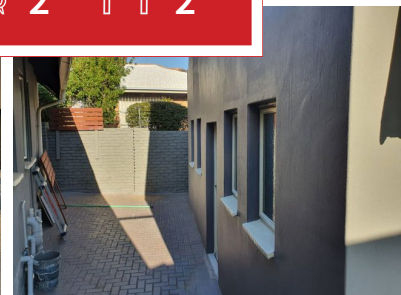

New Listing! Lovely Cape Dutch style family home in Noordheuwel.

This open plan family home with granite top kitchen with a gas hob is well designed and modern. The Reception areas are spacious and the bedrooms nice and sunny. The wooden ceiling and laminated floors finish it off very well. The thatch lapa is spacious and ideal for entertaining , braaiing and the pool is TLC. There is a landscaped garden which is fully walled. Both garages are automated and there is a carport and extra parking for another 4 vehicles. Security is ample and there is a domestic room.

Please contact me to arrange your appointment for viewing.

Monthly Bond Repayment

Calculated over 20 years at 11% with no deposit.

R17,547.20

Bond Costs

These calculations are only a guide. Please ask your conveyancer for exact calculations

R30,875.00

Transfer Costs

R55,039.00

Monthly Rates

R1,000



INTERIOR

Bedrooms	3
Bathrooms	2
Kitchens	1
Recep. Rooms	4
Furnished	Maybe

EXTERIOR

Carports / Parkings	5
Security	Yes
Dom. Accom.	1
Pool	Yes
Views	Maybe

SIZES

Floor Size	-
Land Size	1,000m ²



Alf Prinsloo
Property Practitioner

Registered with PPRA (FFC 2023326287)

082 497 5435
alfjoeye@lantic.net



Joey Prinsloo
Property Practitioner

Registered with PPRA (FFC 2023326275)

084 602 8836
joey@finehome.co.za

